

FS180-1200



Technische Infos

Höhe (Dicke)	180mm
Breite	1200mm
Feuerwiderstand	1 Stunde (2 Stunden auf Anfrage)
Expositionsklasse	XC1, XC2, XC3 (andere auf Anfrage)
Transportgewicht	2,76 kN/m ²
Gewicht /m	3,31 kN/m
Bemessungsgewicht	2,89 kN/m ² (inklusive Füllbeton)
Hohlraumfüllung	10,83 l/m
Füllbeton	5,1 l/m ²
Betongüte	C 50/60
Stahlqualität	f(pk) 1860

Keurmerken



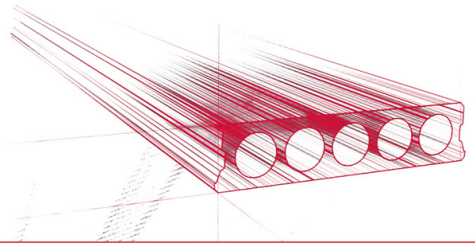

Spannweiten

Zie hiervoor onze online rekenmodule



Passplatten

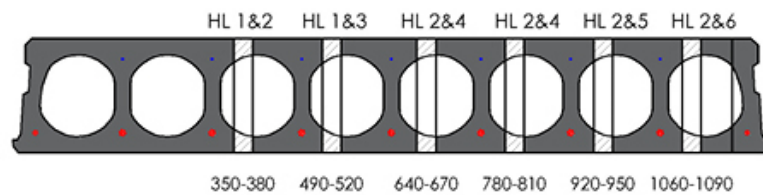



Bohrvorschriften

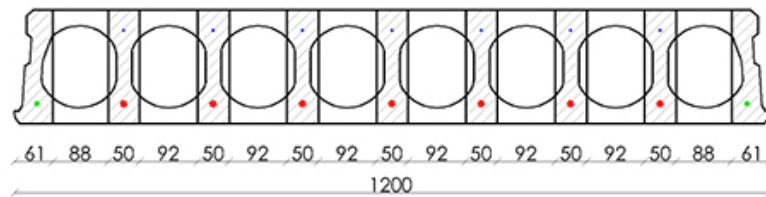

Bewehrungspositionen

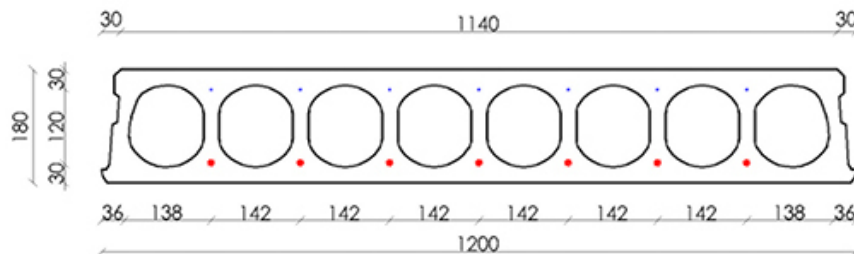



Zubehör

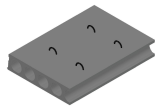

Passplatten -
Spannbeton-Hohlplatte

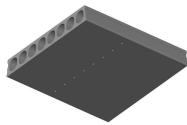

Entwässerungsöffnungen

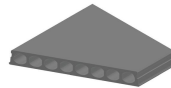

Schrägschnitte

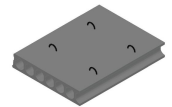

Hubschlaufen

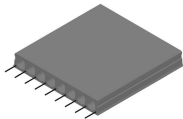

Ausstehende Bewehrung

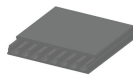

Verjüngte Oberseite

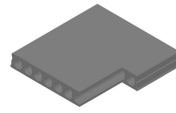

Eckausparungen

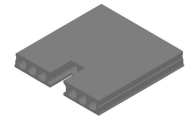

Kopfausparung

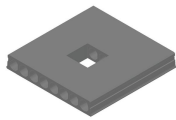

Mittelausparung

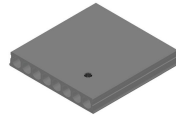

Rundausparung + E-
Dose

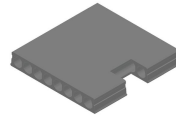

Randausparung

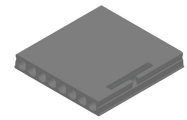

Ausnehmungen zur
Plattenkopplung

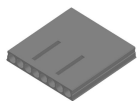

Geöffnete Hohlkammern

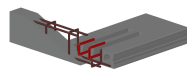

Open kanalen met
inhangwapening

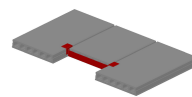

Wechseleisen
Spannbeton-Hohlplatten

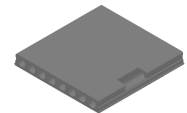

Vertiefte Ausparungen

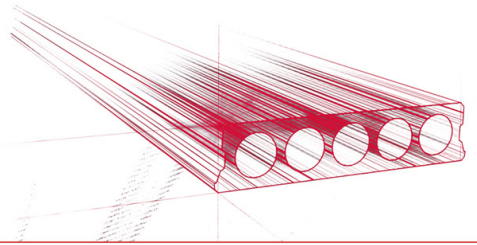

Vorrat

	Produktion	Abnehmbar	Vorrätig
Malle 1			
Malle 2	X	X	
Frederickx			
Tessengerlo			

