



# FS150-1200



## Technische Infos

Höhe (Dicke)	150mm
Breite	1200mm
Feuerwiderstand	1 Stunde (2 Stunden auf Anfrage)
Expositionsklasse	XC1, XC2, XC3 (andere auf Anfrage)
Transportgewicht	2,60 kN/m <sup>2</sup>
Gewicht /m	3,12 kN/m
Bemessungsgewicht	2,70 kN/m <sup>2</sup> (inklusive Füllbeton)
Hohlraumfüllung	7,56 l/m
Füllbeton	4,1 l/m <sup>2</sup>
Betongüte	C 50/60
Stahlqualität	f(pk) 1860

## Keurmerken





## Spannweiten

---

Zie hiervoor onze online rekenmodule



## Passplatten

---

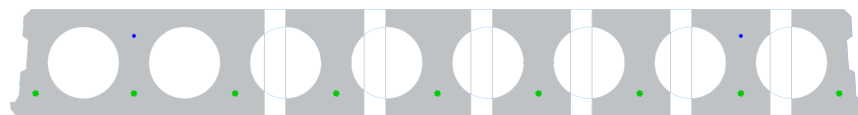

350-380 490-520 640-670 780-810 920-950 1060-1090



## Bohrvorschriften

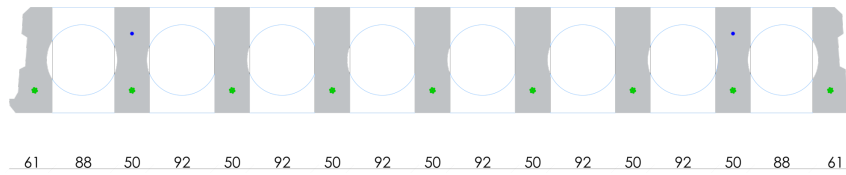

## Bewehrungspositionen

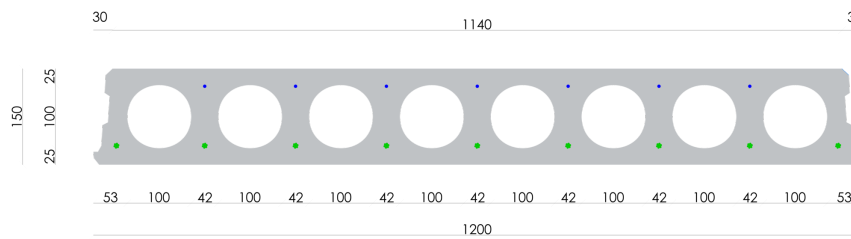

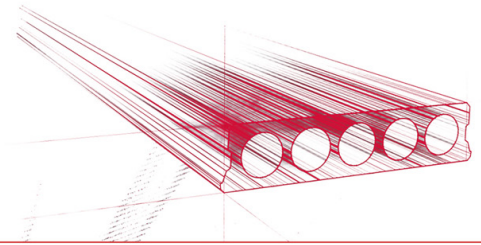

## Zubehör

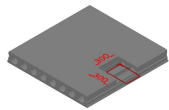

Koppelsparung  
(hamerkop)



Passplatten -  
Spannbeton-Hohlplatte

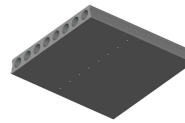

Entwässerungsöffnungen

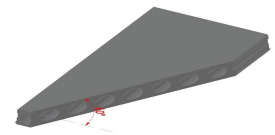

Schrägschnitte

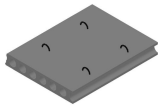

Hubschlaufen

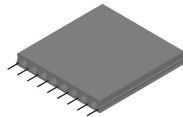

Ausstehende Bewehrung

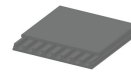

Verjüngte Oberseite

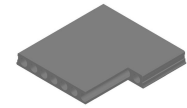

Eckaussparungen

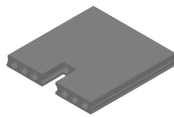

Kopfaussparung

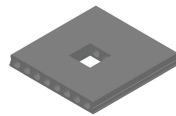

Mittelaussparung

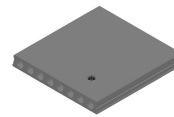

Rundaussparung + E-  
Dose

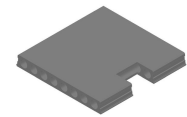

Randaussparung

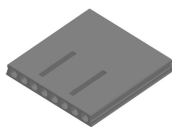

Geöffnete Hohlkammern

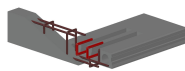

Open kanalen met  
inhangwapening

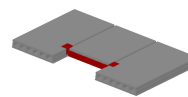

Wechseleisen  
Spannbeton-Hohlplatten

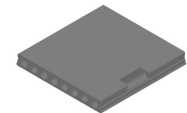

Vertiefte Aussparungen



## Vorrat

	Produktion	Abnehmbar	Vorrätig
Malle 1			
Malle 2	X	X	
Frederickx			
Tessenderlo	X	X	

